

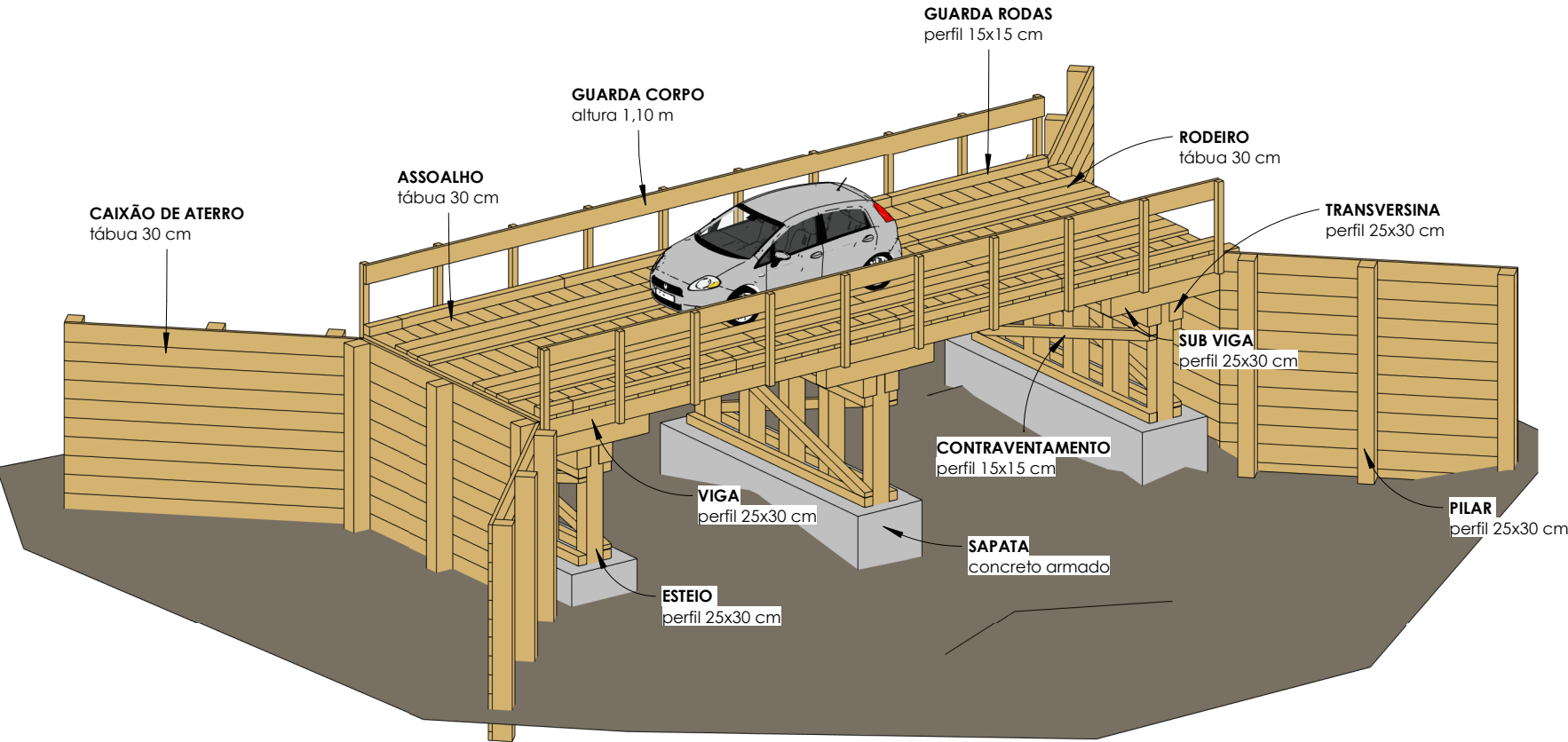

COORDENADA GEOGRÁFICA: 14°48'18.35"S 54°51'46.27"W



1

Maquete 3D

 NOVA BRASILÂNDIA PREFEITURA	Ponte de Madeira Córrego Azul 2	Título:

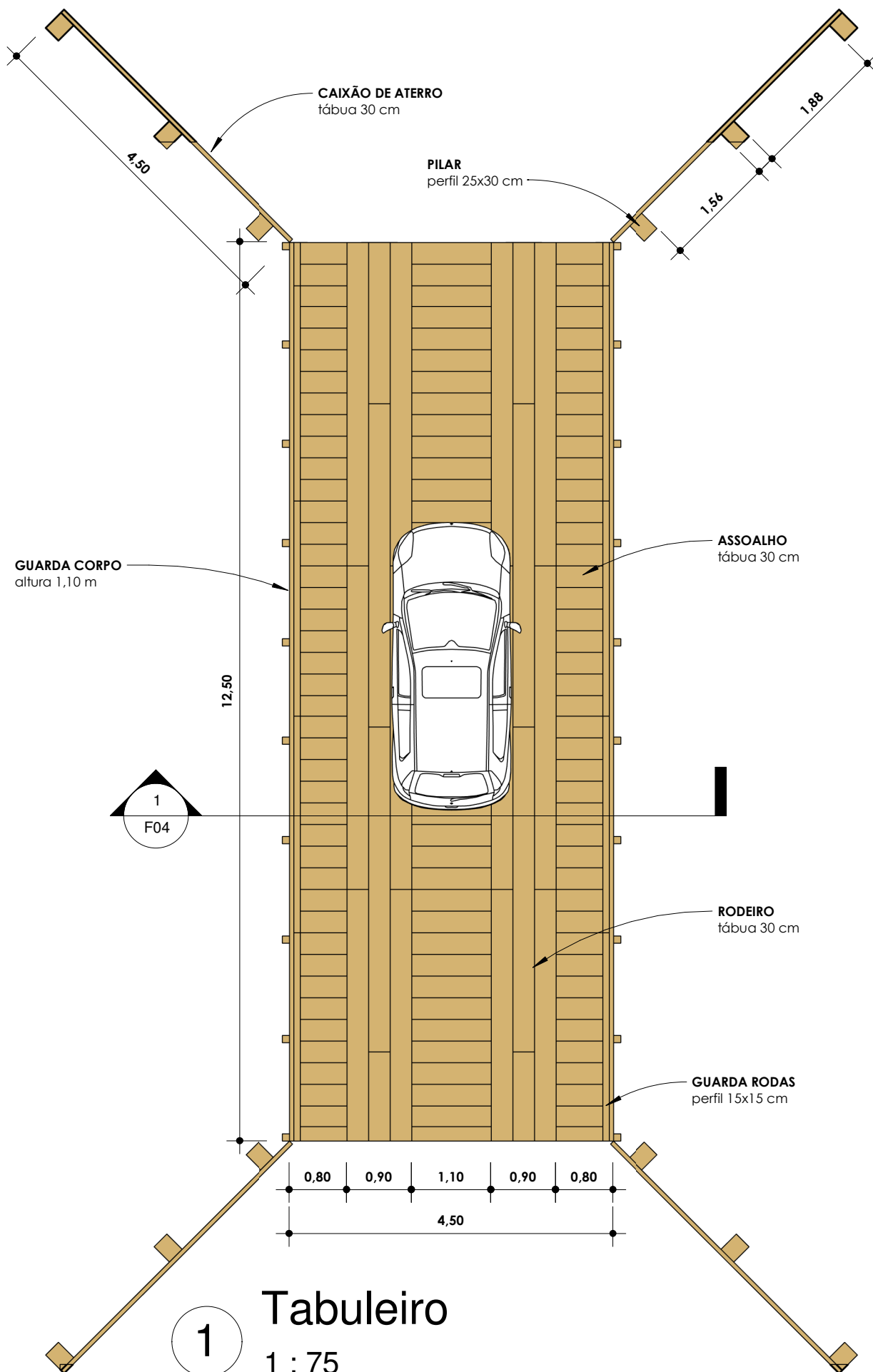

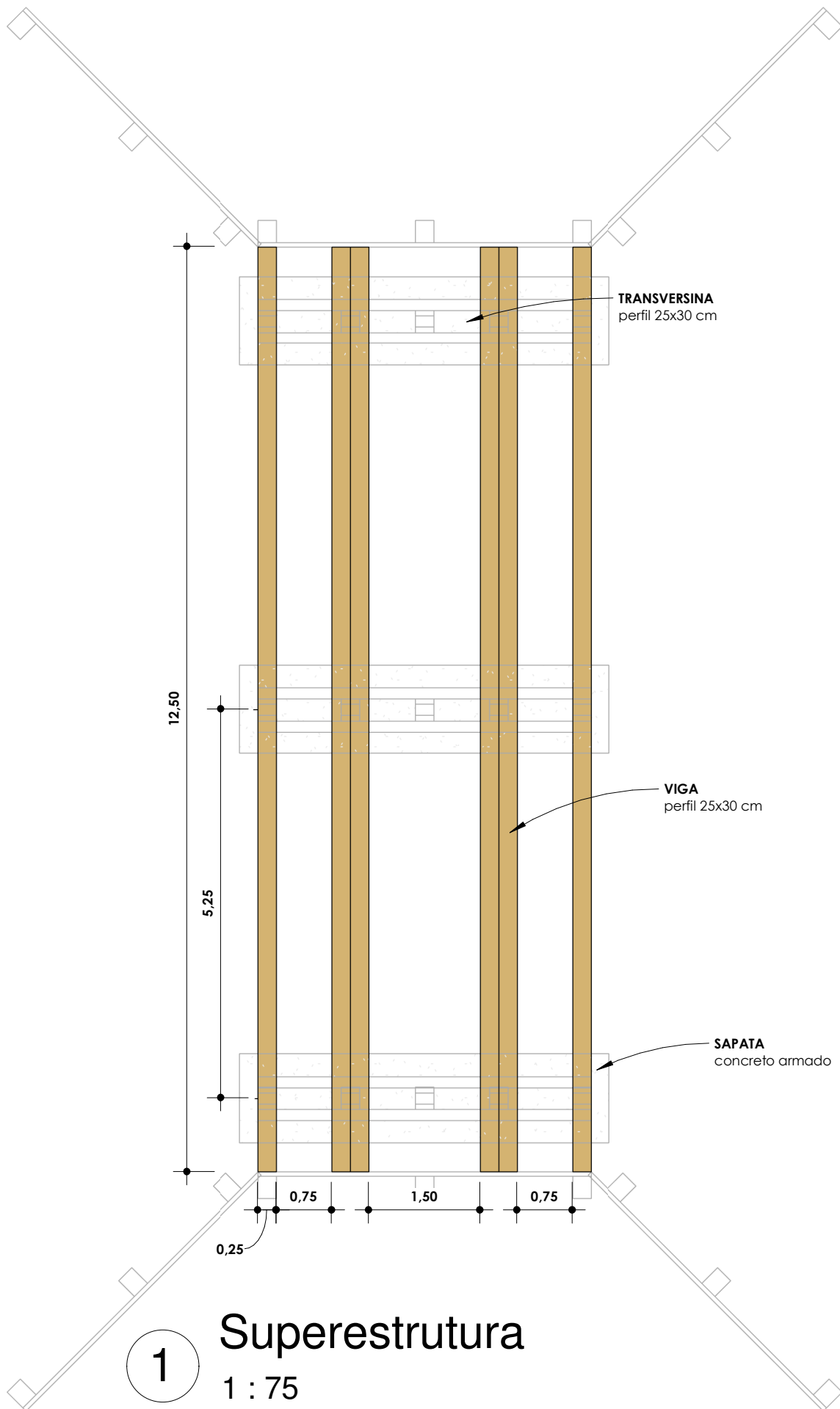

1

Superestrutura

1 : 75

Título:	Ponte de Madeira Córrego Azul 2	Tipo: Projeto de Obra de Arte	Assunto: Superestrutura		
			Escala:	1 : 75	Folha: F03

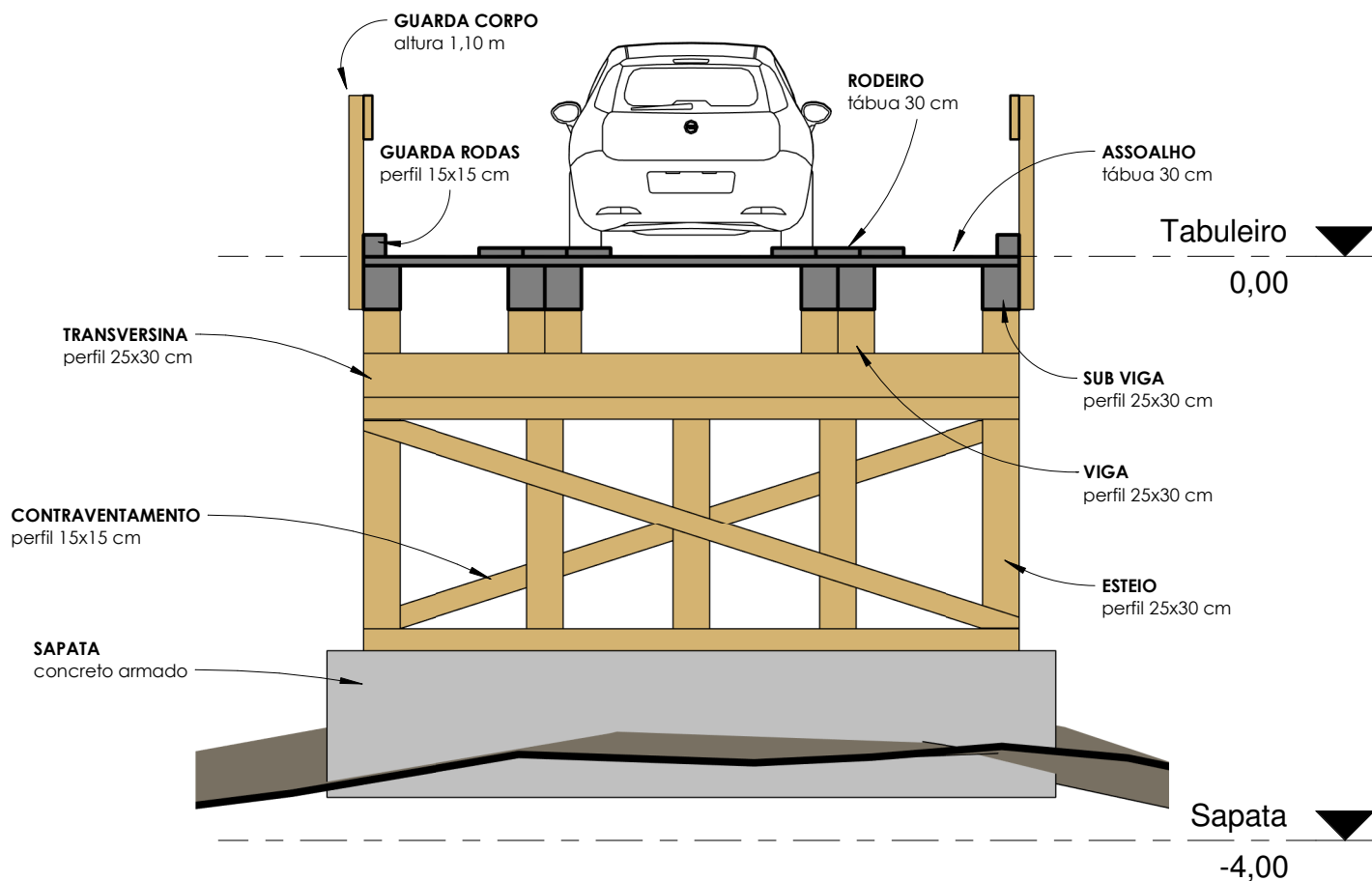

1 **Corte AA**
1 : 50

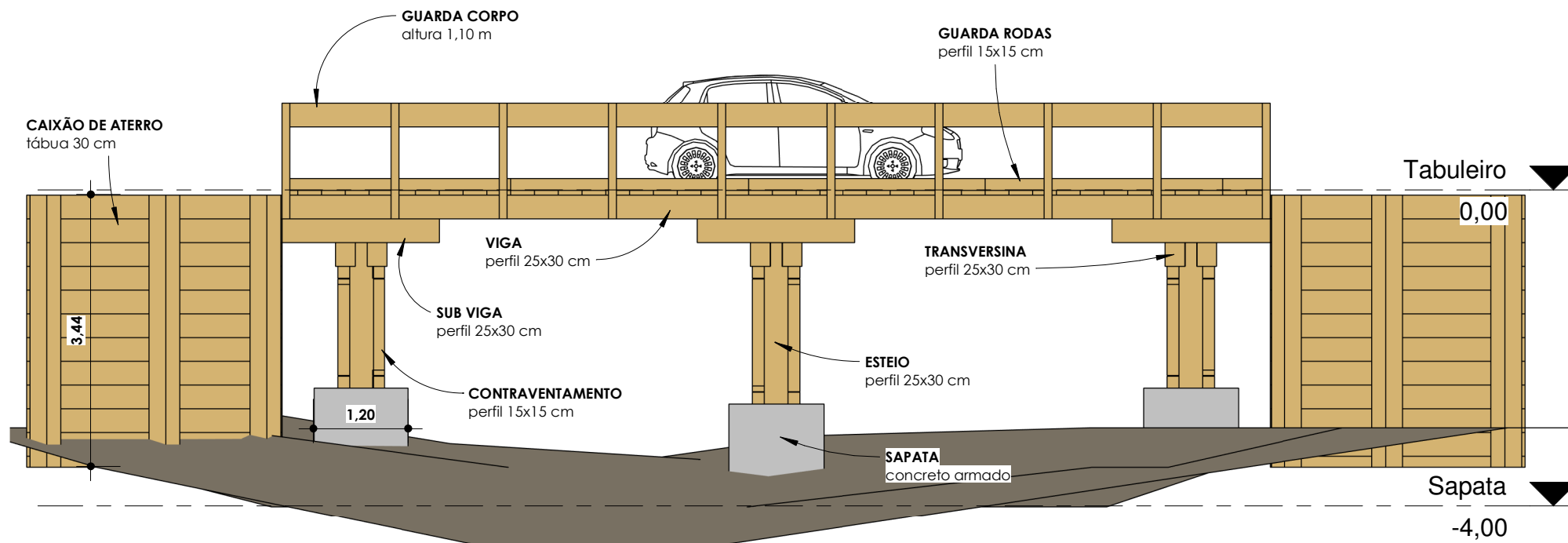

1

Elevação Lateral

1 : 75